

Remote control 2 guide



unitron. Hearing matters

Thank you

Thank you for choosing remote control 2 for your Unitron hearing aids.

At Unitron, we care deeply about people with hearing loss. We work closely with hearing healthcare professionals to make advanced, purpose-driven solutions available to everyone. Because hearing matters.

The intended use of the remote control 2 is to enable easy changes of your hearing aid programs and volume.

 **The remote control 2 must be configured for your hearing aids by your hearing healthcare professional before you can use it.**

Your remote control 2

Hearing healthcare professional: _____

Telephone: _____

Serial number: _____

Replacement batteries: One AAA (1.5 Volt)

Warranty: _____

Date of purchase: _____

Battery size



AAA

Low battery warning



Light indicator changes to yellow or red

Changing batteries

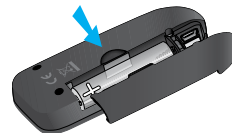

Quick reference

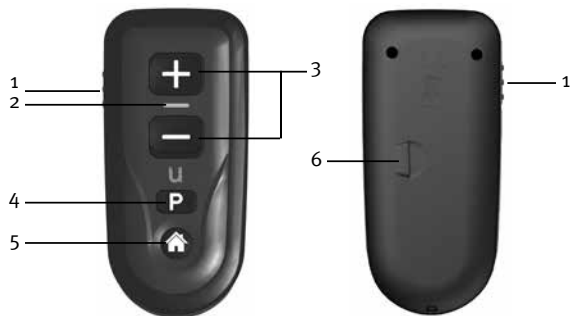

- 1 On/Off switch
- 2 Indicator light
- 3 +/- buttons
- 4 Program change button
- 5 Home button
- 6 Battery compartment

On/Off

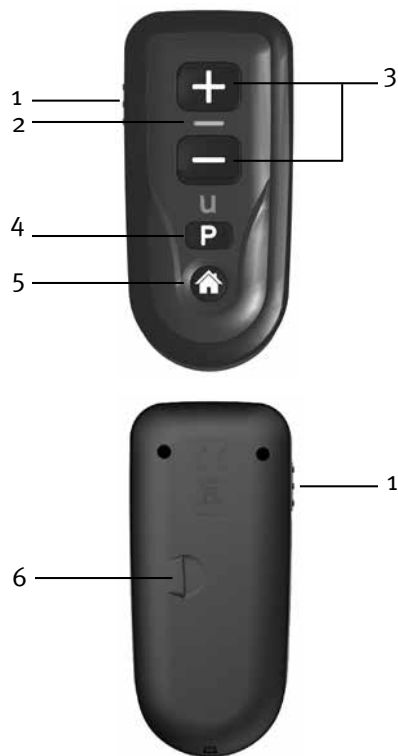

Table of contents

Your remote control 2 at a glance.....	2
Turning your remote control 2 on and off.....	4
Replacing the battery.....	5
Operating instructions.....	7
Understanding the indicator light.....	9
Adjusting your hearing aids with your remote control 2.....	10
Caring for your remote control 2.....	12
Cleaning your remote control 2.....	13
Troubleshooting guide.....	14
Warnings.....	16
Information and explanation of symbols.....	21
Compliance information.....	23

Your remote control 2 at a glance

- 1 **On-off switch** - turn your remote control on or off and lock it to avoid sending unintentional commands
- 2 **Indicator light** - will light up when you turn on the remote control or press any button
green light = battery OK
yellow light = low battery
red light = very low battery
- 3 **+/- buttons** - adjusts the volume of your hearing aids
- 4 **Program change button** - advances your hearing aid to the next listening program
- 5 **Home button** - returns your hearing aids to their start-up program and start-up settings
- 6 **Battery compartment** - allows access to change the battery



Turning your remote control 2 on and off

Your remote control has an On-Off switch located on the left side of the remote.

- To turn the remote control on, slide the switch to the On or unlocked position, revealing a white dot.
- To turn the remote control off, slide the switch to the Off, hiding the white dot. Sliding the switch to the Off position will avoid sending unintentional commands to your hearing aids (while the device is in your handbag or pocket).



Replacing the battery

The battery compartment is located on the back of the remote.

1. Slide the battery cover in the direction of the arrow.
2. Grasp the old battery with your thumb and index finger and remove.
3. Insert the new battery into the battery compartment in the correct +/– position, placing the battery's minus (–) end into the compartment first.
4. Slide the battery cover in the opposite direction of the arrow.

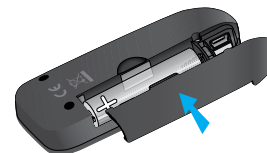
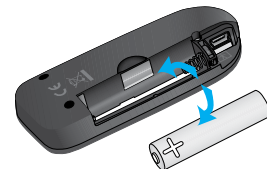
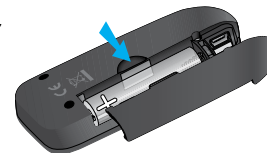

 The mini-USB port cannot be used for battery charging. It is to be used for programming purposes by your hearing healthcare professional.

Low battery warning

When the indicator light shines yellow or red instead of green, your remote control is warning you that the battery in your remote is low. You will see the warning every time you turn on your remote control or send a command to your hearing aids until you change the battery or the battery dies.

Caring for batteries

Always discard batteries in a safe and environmentally friendly way.

To prolong battery life, remember to turn the remote control off when not in use.

Operating instructions

Before using your remote control 2, turn on your hearing aids to ensure they are able to receive the remote commands.

Your remote is designed to be used comfortably in your hand at a maximum distance of one arm's length (1 m/40"). Hold the remote so the buttons are facing you, however, you do not have to point the remote at your hearing aids. Placing the remote directly next to or too close to your hearing aids may decrease the remote's effectiveness.

- ⚠ The mini-USB port is to be used for programming purposes only by your hearing healthcare professional.

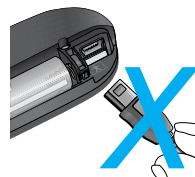

- ⚠ Interference with medical devices: This remote control uses low-power, digitally coded transmission to communicate to your hearing system. Although unlikely,

interference with medical devices such as pacemakers is possible. Therefore pacemaker users must not keep this remote in or near a breast pocket.

Understanding the indicator light

When turning on the remote control 2, the indicator light will switch on for two seconds, indicating that the remote is ready to use. The indicator light remains on as long as a button is pressed.

 If the indicator does not blink when a button is pressed, the remote needs to be programmed by your hearing healthcare professional.

The indicator light will be either green or red, depending on the battery status.

Green: battery OK

Red: < 10% battery left.

Replace the battery immediately.

Adjusting your hearing aids with your remote control 2

+/- buttons as volume control

 Press + to increase the volume

 Press – to decrease the volume

As the volume is adjusted, your hearing aids may beep. Please refer to your hearing aid guide for more information on your hearing aid volume beeps.

Program change button

 Press the program change button to change to the next listening program in your hearing aids. Please refer to your hearing aid guide to determine which programs are available to you and your program beep notifications.

Home button

 Press the home button to return your hearing aids and settings to their start-up program and the settings. Please refer to your hearing aid guide to determine which program is your start-up program.

Press and hold the home button for two seconds to activate your main hearing program as configured by your hearing healthcare professional.

 Your hearing aids will beep to confirm chosen selection.

 Changes are applied to both hearing aids at the same time.

Caring for your remote control 2

- Open the battery compartment and remove the battery if the remote control will not be used for long periods of time.
- Do not use your remote in the bath or shower or immerse it in water.
- If your remote does become wet, do not attempt to dry it in an oven or microwave. Do not adjust any controls. Open the battery compartment and allow your remote control to dry naturally for 24 hours.
- Protect your remote from excessive heat (hair dryer, vehicle glove box or dashboard).
- Do not drop your remote or knock it against hard surfaces.
- If the hearing aids do not respond to the device because of an unusual field disturbance, move away from the disturbing field.

Cleaning your remote control 2

Use a damp cloth to clean the outside of the remote. Do not use household cleaning products (washing powder, soap, etc.) or alcohol to clean the device. Never use a microwave or other heating device to dry your remote.

Troubleshooting guide

You can refer to the troubleshooting table below if you are experiencing problems with your remote control. For problems with your hearing aids, please consult your hearing aid guide.





Cause	Possible remedy
Indicator light not working	
Not turned on	Turn on
Low/dead battery	Replace battery
Poor battery contact	Consult your hearing healthcare professional
Battery upside down	Insert battery plus (+) side up
Indicator light is yellow or red	
Low battery	Replace battery
Hearing aids not responding to remote control commands	
Holding the remote too far away	Move the remote a maximum distance of one arm's length

For any problems not listed in the guide, contact your hearing healthcare professional.

Warnings

 Please read the information on the following pages before using your Unitron remote control.

Hazard warnings

-  Keep this device out of reach of pets and children under 3 years.
-  Only use hearing aids that have been specifically programmed for you by your hearing healthcare professional.
-  Changes or modifications to any of the devices that were not explicitly approved by Unitron are not permitted.
-  This remote control uses low-power, digitally coded transmission to communicate to your hearing system. For persons with active implantable medical devices, (i.e. pacemakers, defibrillators, etc.) caution should be exercised when using this device.
-  Dispose of electrical components in accordance with your local regulations.

- ⚠ Do not use the device in explosive areas (mines or industrial areas with danger of explosions, oxygen rich environments or areas where flammable anesthetics are handled) or where electronic equipment is prohibited.
- ⚠ External devices may only be connected if they have been tested in accordance with corresponding IECXXXXX standards. Only use accessories approved by Unitron.
- ⚠ When operating machinery, ensure that no parts get caught in the machine.
- ⚠ The mini-USB port is to be used for the described purpose only.
- ⚠ Using the device, its connectors or cables in any way contradictory to their intended purpose as described in this user guide (e.g., wearing the USB cable around the neck) can cause injury.
- ⚠ Only use accessories approved by Unitron to avoid any electrical shock.

Battery warnings

- ⚠ Never leave your remote control or batteries where small children and pets can reach them.
- ⚠ Remove the battery if you are not using the remote control for a long period of time.
- ⚠ Never put your remote control or batteries in your mouth. If a battery is swallowed, call a physician immediately.
- ⚠ Always use a high quality, long-life alkaline battery as a replacement and dispose of the old one in an environmentally-friendly way. Do not use rechargeable batteries.

Precautions

- ⚠ Your remote control should only be used as directed by your hearing healthcare professional.
- ⚠ If your remote control fails to operate after you have correctly inserted a new battery, contact your hearing healthcare professional.

- ⚠ Special medical or dental examination including radiation described below, may adversely affect the correct functioning of your remote. Remove and keep it outside the examination room/area before undergoing a medical or dental examination with X-ray (also CT scan) or any medical examinations with MRI/NMRI scans, generating magnetic fields.
- ⚠ Always bring both your remote control and your hearing aids for service questions.
- ⚠ Your remote control and your hearing aids are given a unique communication code. Because of this code, your remote control will not affect hearing aids worn by others.
- ⚠ Your remote control uses the most modern components to provide an extremely reliable experience with virtually no interference from other devices. However, when operating the remote control near a computer terminal, communication device

such as a digital cell phone, or other strong electromagnetic field, it may be necessary to be at least 24 inches (60 centimeters) away to ensure proper operation.

- ⚠ If your hearing aids do not respond to the remote control because of an unusual field disturbance, move away from the disturbing field.
- ⚠ Keep the device at least 10 cm away from any kind of magnets.
- ⚠ High-powered electronic equipment, larger electronic installations and metallic structures may impair and significantly reduce the operating range.

Labeling

The serial number and year of manufacture are located inside the battery compartment.

Please fill out the contact information sticker provided with your new remote control and affix it to the inside of the battery door.

Information and explanation of symbols



With the CE symbol, Unitron confirms that this Unitron product – including accessories – meets the requirements of the Medical Devices Directive 93/42/EEC as well as the Radio Equipment Directive 2014/53/EU on radio and telecommunications transmitters.

The numbers after the CE symbol correspond to the code of certified institutions that were consulted under the above-mentioned directives.



This symbol indicates that it is important for the user to read and take into account the relevant information in this user guide.



This symbol indicates that it is important for the user to pay attention to the relevant warning notices in this user guide.



Important information for handling and effective use of the product.



Australia and New Zealand EMC and Radiocommunications compliance label.



This symbol indicates that the products described in these user instructions adhere to the requirements for an application part of Type B of EN 60601-1. The surface of the hearing aid is specified as application part of Type B.



Copyright symbol



This symbol shall be accompanied by the name and the address of the authorised representative in the European Community.



This symbol shall be accompanied by the name and the address of the manufacturer (who are placing this device on the market).

Operating conditions:

This device is designed such that it functions without problems or restrictions if used as intended, unless otherwise noted in these user guides.

-10° – 55° Celsius and relative humidity of <95% (non condensing).

Transport conditions:

Temperature: -20° to +60° Celsius (-4° to +140° Fahrenheit).
Humidity: Up to 90% (non condensing).

The air pressure between 500 and 1100 hPa is appropriate.



The symbol with the crossed-out garbage bin is to make you aware that this device may not be thrown away as normal household waste. Please dispose of old or unused devices, at waste disposal sites intended for electronic waste, or give your device to your hearing healthcare professional for disposal. Proper disposal protects the environment and health.

Compliance information

Declaration of Conformity

Hereby, Unitron Hearing declares that this product meets the requirements of the Medical Device Directive 93/42/EEC and complies with Radio Equipment Directive 2014/53/EU. The full text of the Declarations of Conformity can be obtained from the manufacturer.

Notice 1:

This device complies with Part 15 of the FCC Rules and with RSS-210 of Industry Canada. Operation is subject to the following two conditions:

- 1) this device may not cause harmful interference, and
- 2) this device must accept any interference received, including interference that may cause undesired operation.

Notice 2:

Changes or modifications made to this device not expressly approved by Unitron may void the FCC authorization to operate this device.

Notice 3:

This device has been tested and found to comply with the limits for a Class B digital device, pursuant to Part 15 of the FCC Rules and ICES-003 of Industry Canada. These limits are designed to provide reasonable protection against harmful interference in a residential installation. This device generates, uses and can radiate radio frequency energy and, if not installed and used in accordance with the instructions, may cause harmful interference to radio communications. However, there is no guarantee that interference will not occur in a particular installation. If this device does cause harmful interference to radio or television reception, which can be determined by turning the equipment off and on, the user is encouraged to try to correct the interference by one or more of the following measures:

- Reorient or relocate the receiving antenna.
- Increase the separation between the device and receiver.
- Connect the device into an outlet on a circuit different from that to which the receiver is connected.
- Consult the dealer or an experienced radio/TV technician for help.



Australia: Supplier Code Number N15398

New Zealand: Supplier Code Number Z1285



Unitron Hearing, a division of
National Hearing Services Inc.
20 Beasley Drive, P.O. Box 9017,
Kitchener, ON N2G 4X1 Canada



Sonova AG
Laubisrütistrasse 28
CH-8712 Stäfa, Switzerland

For a listing of Unitron group
companies, please visit
www.unitron.com





Distributor

unitron.com

